



Be ahead



LUX





LUX



Hydraulic automation systems for swing gates

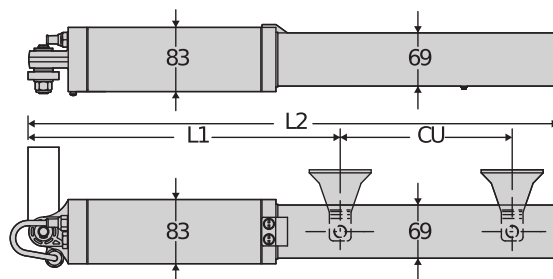

	L1	CU	L2
LUX / LUX B / LUX 2B	715	270	1025
LUX FC 2B	850	280	1320
LUX R 2B SN2	710	250	1050
LUX MB / LUX L	715	270	1025
LUX G	850	390	1300

Complete range of low voltage hydraulic pistons for very intensive use, suitable for any type of residential, industrial or multi-residence application. Compact and sturdy, capable of automating swing gate leaves up to 5 metres wide and weighing up to 800 kg. Available in both reversible and irreversible versions, with maximum precision in torque control guaranteed by by-pass valves.

Relevant features



All-aluminium structure with high-resistance anodising treatment.



The by-pass valves, in the 230V versions, allow the exact setting of the torque separately and independently for opening and closing.



The slowdown during closing (R versions) guarantees silent, smooth movements on even the biggest gates. Also, the adjustment screw makes it possible to adapt the slowdown intensity to needs of each situation.



Hydraulic automation systems for swing gates

LUX

Code	Name	Description
P935009 00001	LUX	Hydraulic operator 230 V for hinged leaves up to 2 m and 300 kg in weight. Useful travel 270 mm, manoeuvre time 17 s and maximum opening angle 123 °. Locking system: Solenoid Lock Reversible
P935011 00001	LUX 2B	Hydraulic operator 230 V for hinged leaves up to 2 m and 300 kg in weight. Useful travel 270 mm, manoeuvre time 17 s and maximum opening angle 123 °. Locking system: Open/close hydraulics
P935046 00001	LUX R2B	Hydraulic operator 230 V for hinged leaves up to 2 m and 300 kg in weight. Useful travel 270 mm, manoeuvre time 17 s and maximum opening angle 123 °. Locking system: Solenoid Lock Reversible
P935046 00002	LUX R 2B SN2	Hydraulic operator 230 V for hinged leaves up to 2 m and 300 kg in weight. Useful travel 250 mm, manoeuvre time 16+roll. s and maximum opening angle 101 °. Locking system: Open/close hydraulics
P935039 00001	LUX FC 2B	Hydraulic operator 230 V for hinged leaves up to 2 m and 300 kg in weight. Useful travel 280 mm, manoeuvre time 17 s and maximum opening angle 117 °. Locking system: Open/close hydraulics
P935014 00001	LUX GV	Hydraulic operator 230 V for hinged leaves up to 3.5 m and 300 kg in weight. Useful travel 270 mm, manoeuvre time 17 s and maximum opening angle 123 °. Locking system: Solenoid Lock Reversible
P935013 00001	LUX G	Hydraulic operator 230 V for hinged leaves up to 5 m and 800 kg in weight. Useful travel 390 mm, manoeuvre time 48 s and maximum opening angle 130 °. Locking system: Solenoid Lock Reversible

RIGEL 6 220-230V 50/60HZ: Universal control panel with display for one or two 230V - 650+650W operators



D113833 00002 - RIGEL 6 220-230V 50/60HZ - Recommended



- Universal control panel with display for one or two 230V - 650+650W operators
- Application: universal control panel for one or two operators
- Card power supply: 230 V single-phase
- Operators power supply: 230V single-phase 600+600W
- Main features: removable terminal blocks, programming and diagnostics with display, built-in four-channel receiver, electro lock, electronic torque limiter, electronic deceleration at opening and closing, a separate limit switch inputs for each motor, traffic light management, preheating hydraulic operators, weekly timer, possibility to delete a specific remote control, customization of the 4 radio channels, personalization of the duration of the delayed output, adjustable sensitivity to the obstacle.
- Main functions: automatic re-closing, separate motor working times, stays locked when closed, water hammer, 2/3/4 step logic, partial opening, fast closing, separate opening and closing
- Compatibility: RIGEL 5 - RIGEL 4 - RIGEL 3 - RIGEL N

	LUX	LUX 2B	LUX R2B	LUX R 2B SN2
Control unit	RIGEL 6	RIGEL 6	RIGEL 6	RIGEL 6
Motor voltage	230 V	230 V	230 V	230 V
Power consumption	250 W	250 W	250 W	250 W
Max. width of door/gate wing	2 m	2 m	2 m	2 m
Max. weight of door/gate wing	300 kg	300 kg	300 kg	300 kg
Useful rod stroke	270 mm	270 mm	270 mm	250 mm
Maximum angle	123 °	123 °	123 °	101 °
Cycle time	17 s	17 s	17 s	16+roll. s
Type of limit switch	work time	work time	work time	work time
Slowdown	no	no	no	Yes
Locking	Solenoid Lock	Open/close hydraulics	Solenoid Lock	Open/close hydraulics
Release	Reversible	Triangle key	Reversible	Triangle key
Impact reaction	Hydraulic clutch	Hydraulic clutch	Hydraulic clutch	Hydraulic clutch
Frequency of use	very intensive	very intensive	very intensive	very intensive



LUX



Hydraulic automation systems for swing gates

	LUX	LUX 2B	LUX R2B	LUX R 2B SN2
Protection rating	IP57	IP57	IP57	IP57
Environmental conditions	-10 ÷ 60 °C	-10 ÷ 60 °C	-10 ÷ 60 °C	-10 ÷ 60 °C

	LUX FC 2B	LUX GV	LUX G
Control unit	RIGEL 6	RIGEL 6	RIGEL 6
Motor voltage	230 V	230 V	230 V
Power consumption	280 W	250 W	250 W
Max. width of door/gate wing	2 m	3,50 m	5 m
Max. weight of door/gate wing	300 kg	300 kg	800 kg
Useful rod stroke	280 mm	270 mm	390 mm
Maximum angle	117 °	123 °	130 °
Cycle time	17 s	17 s	48 s
Type of limit switch	work time	work time	work time
Slowdown	no	no	no
Locking	Open/close hydraulics	Solenoid Lock	Solenoid Lock
Release	Triangle key	Reversible	Reversible
Impact reaction	Hydraulic clutch	Hydraulic clutch	Hydraulic clutch
Frequency of use	very intensive	very intensive	very intensive
Protection rating	IP57	IP57	IP57
Environmental conditions	-10 ÷ 60 °C	-10 ÷ 60 °C	-10 ÷ 60 °C

RECOMMENDED ACCESSORIES

	N733426 - ARB LUX Adjustable front and rear bracket for LUX operator		N733474 - ARB LUX G Adjustable front and rear bracket for LUX G operator
	D730178 - PLE Anchor plate for attaching the rear mountings to masonry pillars for LUX, ORO, and PHOBOS operators.		N999131 - NAT Adapter for 230V hydraulic operators for inserting the spiral cable protection sheath
	D111013 - ME Control board for 12Vac solenoid lock for 230V automation systems		D610180 - CLS Triangular release key l=52 mm
	P111782 - COMPACTA A20-180 Pair of photocells adjustable 180° horizontally. 20 metre range. 12-33 VAC/15-35 VDC power supply.		D114094 00002 - RADIUS LED AC A RO Flashing light without incorporated antenna for motors with 230 V power supply.
	D114093 00002 - RADIUS LED AC A R1 Flashing light with incorporated antenna for motors with 230 V power supply.		



LUX



Hydraulic automation systems for swing gates

What is U-Link?

The technology that gives you more power

U-Link, Universal Link, is an exclusive BFT platform that can be used to create high-tech ecosystems.

In Home Access Automation, it can be used to communicate with all home access automation devices of any brand. This saves you time and allows you to control everything easily and without any worries.

It is intuitive

Easy to install and to use

It is scalable

You can add as many devices as you want

It is flexible

It allows you to create groups of interconnected products

It is practical

Works with or without an internet connection

It is functional

Its settings can be controlled remotely using dedicated applications



Hydraulic automation systems for swing gates

Everything on one screen: find out more about this amazing technology

A world-exclusive platform that **can be used to create high-tech ecosystems** offering a vast range of solutions for many different sectors.

This proprietary platform which is a key feature of BFT products, thanks to the B-EBA cards and the Clonix U-Link receiver, is suitable for any protocol or product for access automation (including BFT products non-BFT ones and older versions) and it can be used in a variety of different sectors. This means any device becomes a smart device which can be interconnected with other systems, using a language that is becoming universal.



U-Control HOME

U-Control HOME is the application that allows you to open the gate to your home and to remotely control BFT automations using your own smartphone. The iOS version can be used to automatically open the automation when you are close to it.



U-Base 2

A software package for installation, performing maintenance and identifying any faults in the U-Link compatible operators, easily and conveniently.



U-SDK

U-SDK is the application which allows BFT automations to be made compatible and easily integrated with a BMS network.



Clonix U-Link

Connect non-native U-Link and non-BFT products to U-Link systems.

Is it possible to connect non-native U-Link BFT operators or other brands of products to U-Link? Yes, thanks to the Clonix receivers. Accessories which accept no limits.



B-EBA

A direct link to your operators.

The B-EBA expansion cards make it possible to connect external devices such as PCs, smartphones and tablets to a BFT operator and a Clonix receiver or to connect multiple BFT products in a U-Link network. These accessories integrate with U-Link technology and with Bluetooth, Wifi, Z-Wave and TCP/IP protocols as well as with the RS485 serial interface. A device that demonstrates exactly what BFT means by interconnectivity.

