



Be ahead



# QUADRO ESPAS 30





# QUADRO ESPAS 30



## Parking management systems

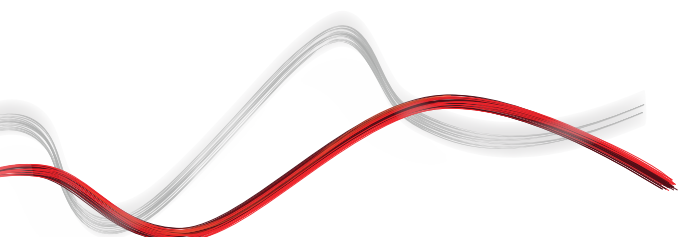
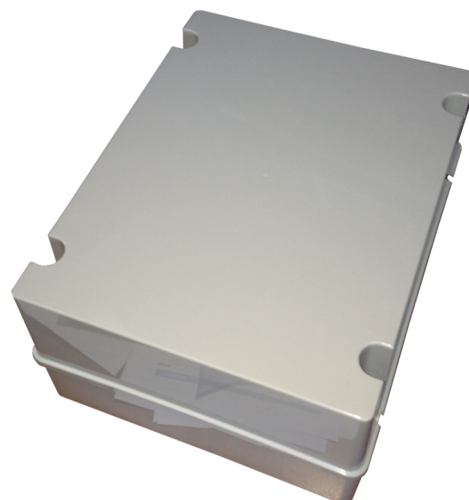
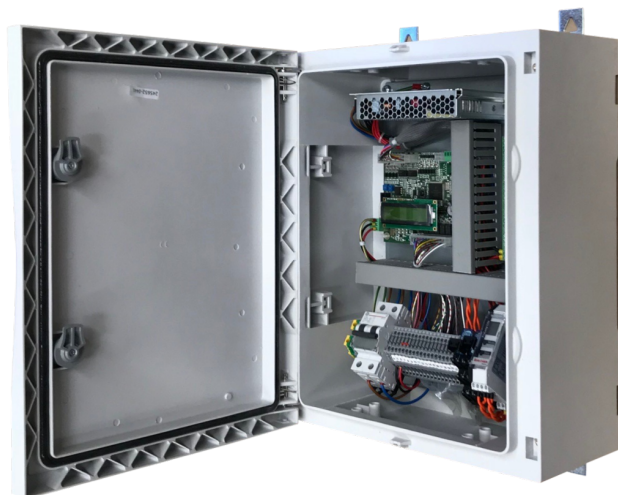



## Parking management systems

### QUADRO ESPAS 30

Kood	Nimi	Kirjeldus
P208005EN-B	QUADRO ESPAS 30 EN	Quadro Espas 30 can be placed aside the lane or at the POS. It works linked to the network of all elements of the Parking System. All function required to manage entry and exit are included. It includes: control board with display and programming joystick, RS485 interface, loop detector. For open air environment the version E with IP66 cabinet ( fiberglass UV resistant and keylock ) is available.
P208005EA-B	QUADRO ESPAS 30 EA	Quadro Espas 30 with RFID 125kHz. It can be placed aside the lane or at the POS. It works linked to the network of all elements of the Parking System. All function required to manage entry and exit are included. It includes: control board with display and programming joystick, RS485 interface, loop detector. For open air environment the version E with IP66 cabinet ( fiberglass UV resistant and keylock ) is available.
P208005IN-B	QUADRO ESPAS 30 IN	Quadro Espas 30 can be placed aside the lane or at the POS. It works linked to the network of all elements of the Parking System. All function required to manage entry and exit are included. It includes: control board with display and programming joystick, RS485 interface, loop detector. IP56 version for in-house installation (I).
P208005IA-B	QUADRO ESPAS 30 IA	Quadro Espas 30 with RFID 125kHz. It can be placed aside the lane or at the POS. It works linked to the network of all elements of the Parking System. All function required to manage entry and exit are included. It includes: control board with display and programming joystick, RS485 interface, loop detector. IP56 version for in-house installation (I).

	QUADRO ESPAS 30 EN	QUADRO ESPAS 30 EA	QUADRO ESPAS 30 IN	QUADRO ESPAS 30 IA
Supply voltage	230 VAC $\pm 10\%$ . 50Hz-60Hz	230 VAC $\pm 10\%$ . 50Hz-60Hz	230 VAC $\pm 10\%$ . 50Hz-60Hz	230 VAC $\pm 10\%$ . 50Hz-60Hz
Standard communication interface	RS485	RS485	RS485	RS485
Sizes	392 x 420 x 180 mm	392 x 420 x 180 mm	316 x 396 x 188 mm	316 x 396 x 188 mm
Operating temperature	-10 $\div$ 50 $^{\circ}\text{C}$	-10 $\div$ 50 $^{\circ}\text{C}$	-10 $\div$ 50 $^{\circ}\text{C}$	-10 $\div$ 50 $^{\circ}\text{C}$
Max power consumption	70 W	70 W	70 W	70 W









### SOOVITATAVAD LISATARVIKUD

	D110945 - <b>MAGNETIC LOOP 6MT</b>		D141784 - <b>MAGNETIC LOOP 8MT</b>
	High sensivity pre-cabled magnetic loop (10m tail x 6m loop)		High sensivity pre-cabled magnetic loop (10m tail x 8m loop)
	 D121458 - <b>TRAFFIC LIGHT 100MM</b>		130198 - <b>TRAFFIC LIGHT LED 100MM</b>
	Traffic light, 2 lights (green/red), diam, 100mm		Traffic light, 2 LEDs light, diam. 100mm
	 130186 - <b>TRAFFIC LIGHT 200MM</b>		130197 - <b>TRAFFIC LIGHT LED 200MM</b>
	Traffic light, 2 lights (green/red), diam, 200mm		Traffic light, 2 LEDs light, diam. 200mm



## Parking management systems

### SOOVITATAVAD LISATARVIKUD

	<b>D113999 - LOOP DETECTOR LITE</b> 2 channel loop detector, 24VDC, up to 4 frequencies per channel for close loop installations, adjustable sensitivity, boost function for sensitivity increase		<b>D113948 - LOOP DETECTOR PRO</b> 2 channel loop detector, 24VDC/AC, up to 4 frequencies per channel for close loop installations, adjustable sensitivity, boost function for sensitivity increase. Direction detection.
	<b>new 394080 - PRESENCE AND SAFETY DETECTOR - LASER LOOPS</b> Presence and Safety laser detector. Its used as an alternative of magnetic loops. Includes one input and two relay outputs. Maximum detection range: 9.9m x 9.9m. 10-35VDC power supply.		<b>new 394073 - LASER SAFATEY DETECTOR</b> Safety laser detector. Its used in combination with magnetic loops in order to add an additional safety device (eg: for pedestrian). Includes two relay outputs. Maximum detection range: 5m x 5m. 10-35VDC power supply.
	<b>new 394075 - LASER DETECTOR REMOTE CONTROL</b> Remote control for settings Safety laser detector and Presence and Safety laser detector.		<b>new P800138 - KIT DENEBO TO DENEBO</b> Additional board used to communicate between two stations in "Two Ways" and "Double Height" configuration. For 30 system only.
	<b>new P800137 - KIT INTERLOCK FOR PARKING</b> Kit for manage interlock function (station between two barriers), useful to prevent queues on the gate or for particularly security requirements. It's usable when a third loop management is required (e.g. motorbike). Includes a loop detector for the second barrier safety loop and a kit of terminals in order to connect the commands of the second barrier.		<b>new P800132 - 485-TCP/IP CONVERTER KIT</b> The device allows the insertion within a wired TCP/IP network of devices using an RS-485 serial interface. The solution is used in all those realities where it is necessary to transmit serial data through, for example, a local network already present.



INFORMATION REGARDING THE PROTECTION OF THE INDUSTRIAL AND INTELLECTUAL PROPERTY RIGHTS OF BFT. BFT S.p.A. protects its industrial property by depositing trademarks, patents, models and designs. The intellectual property of BFT S.p.A. is protected by copyright law. BFT S.p.A. also protects its know-how by taking measures to protect the technical and commercial information inherent in its company and products. All the products in this catalogue are ORIGINAL BFT MODELS and only BFT S.p.A. is authorised to produce them and market them anywhere in the world. All the commercial names in this catalogue are owned by BFT S.p.A., and only BFT S.p.A. is authorised to use them in relation to the corresponding merchandise category. FALSIFIERS WILL BE PROCEEDED AGAINST IN ACCORDANCE WITH BOTH CIVIL AND CRIMINAL LAW. THESE CONDITIONS NOT ONLY GUARANTEE THE INTELLECTUAL PROPERTY RIGHTS OF BFT, BUT ALSO PROTECT CUSTOMERS BY GUARANTEEING THAT THE PRODUCTS THEY ARE PURCHASING ARE ORIGINAL BFT PRODUCTS RESULTING FROM STUDIES AND DESIGNS WITHIN THE BFT COMPANY.