



Be ahead



VISTA SL





VISTA SL



Automation systems for automatic pedestrian doors



Empowered by
U-LINK

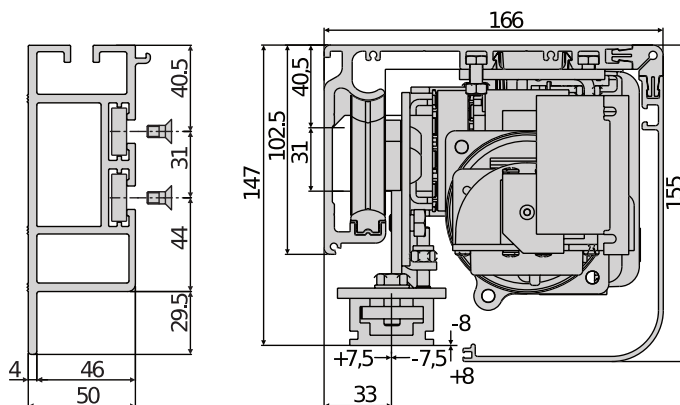

Complete range of automation systems for sliding pedestrian doors with a maximum leaf weight of 150 kg. The control unit, with a programming display and microprocessor technology, makes it possible to control all the main functions automatically. Shock-absorbing track and specially shaped wheels ensure that movement is absolutely silent. U-Link interconnectivity protocol

Relevant features



Electrical locking with the holding of the doors at each stop position.



WMP rapid assembly profile.



Control unit with programming display and autoset system for movement and torque parameters. Incorporated dual channel radio receiver



VISTA SL



Automation systems for automatic pedestrian doors



Empowered by
U-LINK

VISTA SL

| Code | Ci | Name | Anodised casing | Description | |
|---------------|---------|--------------|-----------------|---|--------|
| P960525 00002 | 2605457 | VISTA SL-217 | P111422 00002 | Operator for pedestrian sliding doors with 2 leaf with max weight 120+120 kg. useful passage 1700 mm and crosspiece width 3600 mm. For very heavy gate leaves | U-Link |

| | VISTA SL-2 |
|---------------------------|---------------------------------------|
| Control unit | ARIA EVO |
| Motor voltage | 24 V |
| Nominal power consumption | 230 W |
| Leaf type | Sliding |
| Number of doors | 2 |
| Door weight | 120+120 kg |
| Manual cycle | Reversible |
| Motor type | Dunker motor |
| Type of limit switch | Encoder + mechanical stop for opening |
| Clear opening | 1700 mm |
| Opening speed | up to 200 |
| Closing speed | up to 200 |
| Approach speed | 5 ÷ 10 |
| Locking | Mechanical |
| Release | Release lever |
| Impact reaction | Electronic torque limiter |
| Use cycle | Continuous |
| Protection rating | IPX0 |
| Environmental conditions | 50 °C |

VITAL ACCESSORIES

| | | | |
|--|--|--|---|
| | Cp D113722 - Ci 2600305 VISTA SEL Function selector for pedestrian door series VISTA SL, SL C, TL | | Cp P111768 - Ci 2607186 BBV BATT MODULO VISTA SL Set of backup batteries for VISTA SL |
| | Cp P111681 - Ci 2611330 PRV AA SL Leaf attachment profile for Vista SL. | | Cp N733408 - Ci 2605036 ERV Electric lock for VISTA SL, SL C, TL (use in conjunction with BBV recommended) |
| | Cp P111653 - Ci 2611314 VIO-DT2 Safety and bi-directional activation sensor, dual technology, monitored | | Cp P111654 - Ci 2611315 VIO-DT1 Safety and mono-directional activation sensor, dual technology, monitored |



Automation systems for automatic pedestrian doors



VITAL ACCESSORIES

| | | | | | |
|--|--|--|--|--|--|
|  | Cp P111655 - Ci 2611316 IXIO-DT1 | | | | |
| | Safety and mono-directional activation sensor, dual technology, monitored, programmable c.telecom. | | | | |

RECOMMENDED ACCESSORIES







| | | | |
|--|---|---|---|
|  | Cp P111445 - Ci 2605122 SBV |  | Cp P111680 - Ci 2611329 WMP SL SLC |
| | Anodised aluminium supporting crosspiece for VISTA SL | | Contains 2 crossbeam support profiles of length L = 1 m each |
|  | Cp P111156 - Ci 2605044 PPR |  | Cp P111158 - Ci 2605045 PGI |
| | Door guide slide for automatic doors with aluminium frame | | Bottom door guide for automatic doors with aluminium frame |
|  | Cp P111720 00002 - Ci 2611347 SASA 1AM SIST SFOND.1 ANTA MOBILE |  | Cp P111721 00002 - Ci 2611348 SASA 1AMF SIST SFOND.ANTE 1 MOB + 1 FX |
| | Breakthrough system kit for 1 movable leaf | | Breakthrough system kit for 1 fixed leaf and 1 movable leaf |
|  | Cp P111722 00002 - Ci 2611349 SASA 2AM SIST SFOND...2 ANTE MOB |  | Cp P111723 00002 - Ci 2611350 SASA 2AMF SIST SFOND.ANTE 2 MOB + 2 FX |
| | Breakthrough system kit for 2 movable leaves | | Breakthrough system kit for 2 fixed leaves and 2 movable leaves |
|  | Cp P111724 00002 - Ci 2611351 SASA BRACKETS FOR LEAF BREAKAGE DETECTION PHOTOC. |  | Cp P111725 00002 - Ci 2611352 SASA PRA 2,5 PROF.PROT.ANTE FX/MOB 2.5M |
| | Bracket kit for mounting FPA1 photocells for leaf breakage detection | | Protection profile for fixed/movable leaf. Length L = 2,5 m |
|  | Cp P111726 00002 - Ci 2613113 SASA PRA 5 PROF. PROTEZ.ANTE FX/MOB, 5M |  | Cp P111607 00002 - Ci 2613082 PRV 40.080 CORNICE ABBATTIMENTO L=6.82 |
| | Protection profile for fixed/movable leaf. Length L = 5 m | | Break-open frame for fixed leaf joint. Length L = 6,82 m |
|  | Cp P111610 00002 - Ci 2613083 PRV 40.120 MONTANTE ABBATTIMENTO L=5.1 | | Cp N733589 - Ci 2613262 PRV 40.A53 CERNIERE PER SASA DX |
| | Break-open upright for fixed leaf joint. Length L = 5,1 m | | Right hinge for joint on fixed leaf |
| | Cp N733590 - Ci 2613263 PRV 40.A54 CERNIERE PER SASA SX |  | Cp P111753 - Ci 2611356 OA-AXIS T |
| | Left hinge for joint on fixed leaf | | Active infrared sensor for activation and security with safety test |
|  | Cp P111751 - Ci 2600816 OA-AXIS II |  | Cp P111754 - Ci 2611357 OA-203C |
| | Active infrared sensor for activation and security | | Active infrared sensor for activation and presence |
|  | Cp P111755 - Ci 2611358 OA-PRESENCE TN |  | Cp P111759 - Ci 2611361 OT 3 |
| | Active infrared sensor for security | | Elbow-operated pushbutton, silver |



Automation systems for automatic pedestrian doors

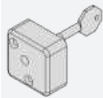

RECOMMENDED ACCESSORIES

| | | | |
|--|--|---|--|
|  | Cp P111656 - Ci 2611317 VIO-ST |  | Cp P111662 - Ci 2611321 VIO-M |
| | Infrared safety sensor, monitored | | Compact mono-directional activation sensor |
|  | Cp P111676 - Ci 2611326 MAGIC SWITCH |  | Cp P111677 - Ci 2611327 PUSH PLATE |
| | Activation touch button | | Activation button |
|  | Cp P111678 - Ci 2611328 SPAC | | Cp P111687 - Ci 2613100 KIT FPA MA-I2 |
| | Pair of locks (2) for glass leaf | | FPA MA 12 kit with two pairs photocells and brackets for Vista |
|  | Cp P111685 - Ci 2605163 KIT FPA2 |  | Cp P111683 - Ci 2605162 KIT FPA1 |
| | FPA kit with two pairs photocells and brackets for Vista | | FPA kit with pair of photocells and brackets for Vista |



VISTA SL



Automation systems for automatic pedestrian doors

EasyAXS

EASY CONNECT. EASY ACCESS.



Empowered by
U-LINK



The new connectivity solution which boosts the potential of BFT products and services to make access automations smarter and easier to use for both installers and end users.





Automation systems for automatic pedestrian doors



EASY TO CONNECT

WIFI MODULE



→ 10/15 metres

WIFI MODULE + ANTENNA



→ 20/25 metres

MOBILE MODULE + ANTENNA + SIM



→ ∞



**PLUG&PLAY
INSTALLATION**



**ALWAYS
CONNECTED**



**EVEN MORE
CONNECTIVITY**



**EASY TO SET UP
FOR INSTALLERS**



**EASY TO CONTROL
FOR CUSTOMERS**





Automation systems for automatic pedestrian doors



Empowered by
U-LINK



U-LINK 2.0

AN UPDATED VERSION OF
U-LINK TO GIVE YOU EVEN
MORE FUNCTIONALITY



Scalable

You can add as many devices as you want



Intuitive

Easy to install and to use



Functional

Settings can be controlled and firmware updated remotely using dedicated applications



Practical

Works with or without an internet connection



Flexible

It allows you to create groups of interconnected products

U-Link, the exclusive **BFT** technology platform has evolved to offer improved interaction with the latest generation of technological ecosystems. Its ability to interface with all home access automation access devices has been expanded, meaning it is now a very useful tool for installers. It is also a faster communication protocol with increased security for communicating information.

It allows you to save even more time, checking everything very easily and giving you even more peace of mind.



Automation systems for automatic pedestrian doors



Empowered by
U-LINK

-SECURITY

A NEW AND EVEN MORE SECURE **RADIO PROTOCOL**



➤ **Secure**

By transmitting data protected by a cryptographic key

U-Security is the new technology from **BFT** which incorporates encrypted rolling code thanks to the encryption key which masks the remote control code, meaning that it is impossible to clone a BFT remote control using another brand's model.

The functions of the **Er Ready** system are incorporated and a new procedure is also available for programming remote controls by scanning a QR CODE and using a special app. All products featuring this technology are **REPLAY**, so they can transmit the code to another BFT remote control using a combination of keys.



➤ **Easy**

Pairing a remote control with a receiver can be done easily by scanning the QR code and using the dedicated app



➤ **Universal**

The radio protocol is also compatible with the previous generation of receivers

